

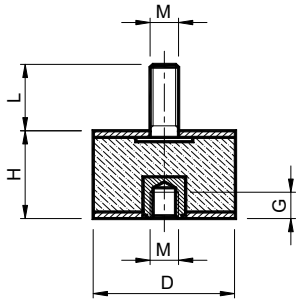

Cylindrical Bobbins: rubber / stainlesssteel – Type: **MF2X** / *Antivibrante Cilindrico: gomma / inox– Tipo: MF2X*



Antivibration mounts made by rubber and steel parts  
**MATERIALS** metal components are in stainless steel  
 NR/SBR rubber compound  
**SHORE** 55° +/-5°  
**USE** male-female

*Antivibranti gomma-metallo*  
**MATERIALI** parti metalliche sono inox  
 Parti in gomma mescola NR/SBR  
**SHORE** 55° +/-5°  
**IMPIEGO** maschio-femmina

Type Tipo	Cod. N°	D	H	L	G	M
MF2X 06-07	AV001483	6	7	6	3	M3
MF2X 08-08	AV001487	8	8	6	3	M3
MF2X 10-07	AV001490	10	7	6	3	M3
MF2X 10-10	AV001491	10	10	10	4	M4
MF2X 10-15	AV001492	10	15	10	4	M4
MF2X 15-8	AV001497	15	8	10	4	M4
MF2X 15-8-6	AV001498	15	8	6	4	M4
MF2X 15-10	AV001499	15	10	10	4	M4
MF2X 15-10-M5	AV001500	15	10	10	4	M5
MF2X 15-15	AV001501	15	15	10	6	M4
MF2X 15-15-M5	AV001502	15	15	8	6	M5
MF2X 15-20	AV001503	15	20	10	4	M4
MF2X 15-30	AV001504	15	30	10	4	M4
MF2X 20-15	AV001517	20	15	18	6	M6
MF2X 20-20	AV001518	20	20	18	6	M6
MF2X 20-25	AV001519	20	25	18	6	M6
MF2X 20-30	AV001520	20	30	18	6	M6
MF2X 25-15	AV001525	25	15	18	6	M6

Type Tipo	Cod. N°	D	H	L	G	M
MF2X 25-20	AV001526	25	20	18	6	M6
MF2X 25-25	AV001527	25	25	18	6	M6
MF2X 25-28	AV001528	25	28	16	6	M6
MF2X 25-30	AV001529	25	30	18	6	M6
MF2X 30-15	AV001533	30	15	20	8	M8
MF2X 30-20	AV001534	30	20	20	8	M8
MF2X 30-25	AV001535	30	25	20	8	M8
MF2X 30-30	AV001536	30	30	20	8	M8
MF2X 30-40	AV001537	30	40	20	8	M8
MF2X 40-15	AV001542	40	15	20	8	M8
MF2X 40-20	AV001543	40	20	23	8	M8
MF2X 40-20-M10	AV001544	40	20	28	10	M10
MF2X 40-25	AV001545	40	25	23	8	M8
MF2X 40-25-M10	AV001546	40	25	28	10	M10
MF2X 40-30	AV001547	40	30	23	8	M8
MF2X 40-30-M10	AV001548	40	30	28	10	M10
MF2X 40-40	AV001549	40	40	23	8	M8
MF2X 40-40-M10	AV001550	40	40	23	10	M10