



PULEGGE DENTATE A BUSSOLA CONICA PER CINGHIE HTD®

HTD® TIMING BELT PULLEYS FOR TAPER BUSHES

8M

PASSO 8 mm

PER CINGHIE LARGHEZZA 30 mm

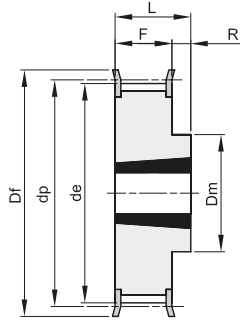

10F

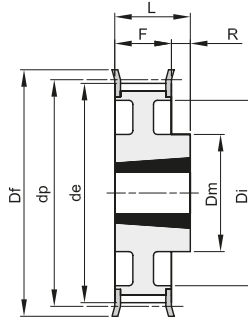

11F

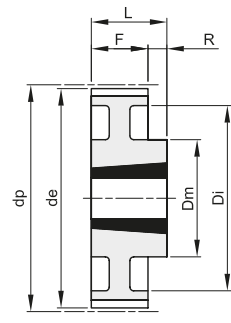

11

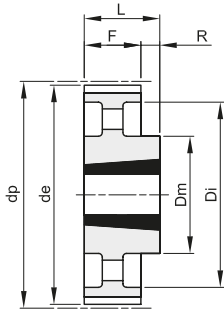

12

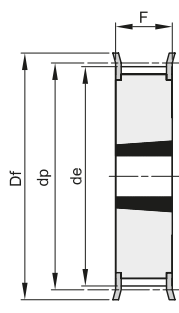

15F

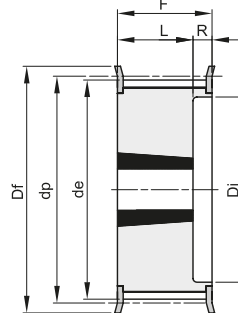

16F

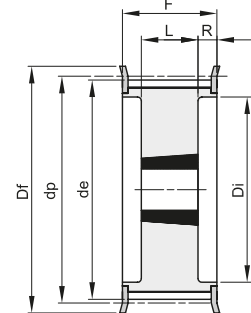

18F

Materiale: Acciaio (St)
Materiale: Ghisa (GG)

| descrizione | codice | tipo | materiale | denti | bussola | foro max | dp | de | Df | Dm | Di | F | L | R | n° flangia | Kg. |
|-------------|----------|------|-----------|-------|---------|----------|--------|--------|-----|-----|-----|----|----|----|------------|------|
| TL 22 8M 30 | 47030022 | 16F | St | 22 | 1008 | 25 | 56,02 | 54,65 | 60 | | 37 | 38 | 22 | 16 | 308 | 0,33 |
| TL 24 8M 30 | 47030024 | 16F | St | 24 | 1108 | 25 | 61,11 | 59,74 | 66 | | 44 | 38 | 22 | 16 | 310 | 0,40 |
| TL 26 8M 30 | 47030026 | 16F | St | 26 | 1108 | 25 | 66,21 | 64,84 | 71 | | 44 | 38 | 22 | 16 | 311 | 0,45 |
| TL 28 8M 30 | 47030028 | 16F | St | 28 | 1210 | 32 | 71,30 | 70,08 | 75 | | 50 | 38 | 25 | 13 | 312 | 0,50 |
| TL 30 8M 30 | 47030030 | 15F | St | 30 | 1615 | 42 | 76,39 | 75,13 | 83 | | | 38 | 38 | | 314 | 0,55 |
| TL 32 8M 30 | 47030032 | 15F | St | 32 | 1615 | 42 | 81,49 | 80,16 | 87 | | | 38 | 38 | | 315 | 0,60 |
| TL 34 8M 30 | 47030034 | 15F | St | 34 | 1615 | 42 | 86,58 | 85,21 | 91 | | | 38 | 38 | | 316 | 0,80 |
| TL 36 8M 30 | 47030036 | 15F | St | 36 | 1615 | 42 | 91,67 | 90,30 | 98 | | | 38 | 38 | | 319 | 1,00 |
| TL 38 8M 30 | 47030038 | 15F | St | 38 | 1615 | 42 | 96,77 | 95,39 | 103 | | | 38 | 38 | | 320 | 1,10 |
| TL 40 8M 30 | 47030040 | 15F | St | 40 | 1615 | 42 | 101,86 | 100,49 | 106 | | | 38 | 38 | | 321 | 1,34 |
| TL 44 8M 30 | 47030044 | 18F | St | 44 | 2012 | 50 | 112,05 | 110,67 | 119 | | 86 | 38 | 32 | 3 | 325 | 1,30 |
| TL 48 8M 30 | 47030048 | 18F | St | 48 | 2012 | 50 | 122,23 | 120,86 | 127 | | 90 | 38 | 32 | 3 | 327 | 1,80 |
| TL 56 8M 30 | 47030056 | 18F | St | 56 | 2012 | 50 | 142,60 | 141,23 | 148 | | 110 | 38 | 32 | 3 | 333 | 3,80 |
| TL 64 8M 30 | 47030064 | 10F | St | 64 | 2517 | 60 | 162,97 | 161,60 | 168 | 125 | | 38 | 45 | 7 | 338 | 4,30 |
| TL 72 8M 30 | 47030072 | 11F | St | 72 | 2517 | 60 | 183,35 | 181,97 | 192 | 125 | 158 | 38 | 45 | 7 | 340 | 4,40 |
| TL 80 8M 30 | 47030080 | 11 | GG | 80 | 2517 | 60 | 203,72 | 202,35 | | 125 | 180 | 38 | 45 | 7 | | 4,65 |
| TL 90 8M 30 | 47030090 | 11 | GG | 90 | 2517 | 60 | 229,18 | 227,81 | | 125 | 204 | 38 | 45 | 7 | | 5,80 |
| TL112 8M 30 | 47030112 | 12 | GG | 112 | 2517 | 60 | 285,21 | 283,83 | | 125 | 254 | 38 | 45 | 7 | | 6,20 |
| TL144 8M 30 | 47030144 | 12 | GG | 144 | 2517 | 60 | 366,69 | 365,32 | | 125 | 336 | 38 | 45 | 7 | | 9,00 |